

**Roseville City School District**

**West Roseville**

**September 14, 2016**

## Current Attendance Boundaries

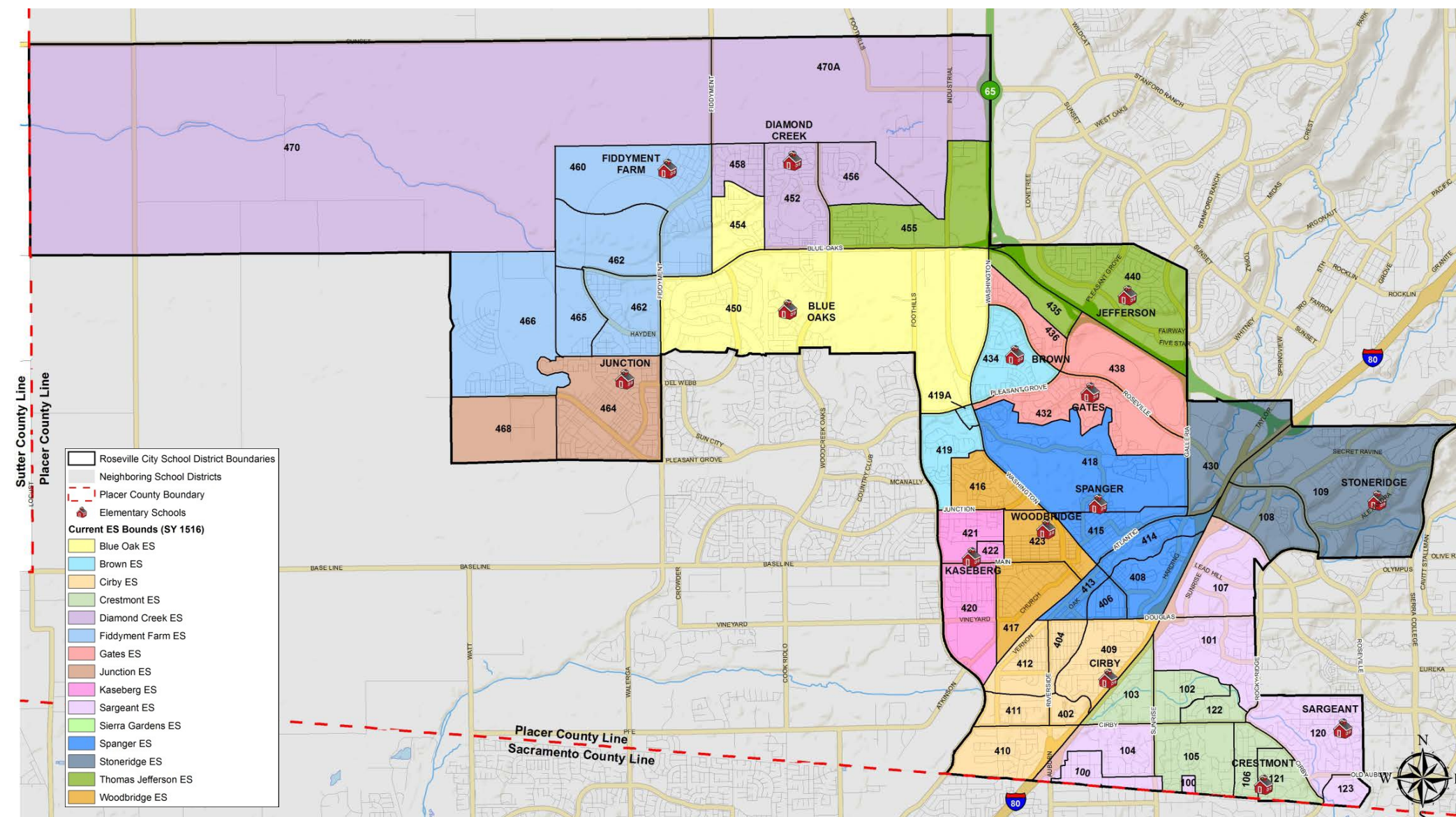



# Approved Attendance Boundaries Opening of W-70 School (2017/2018)

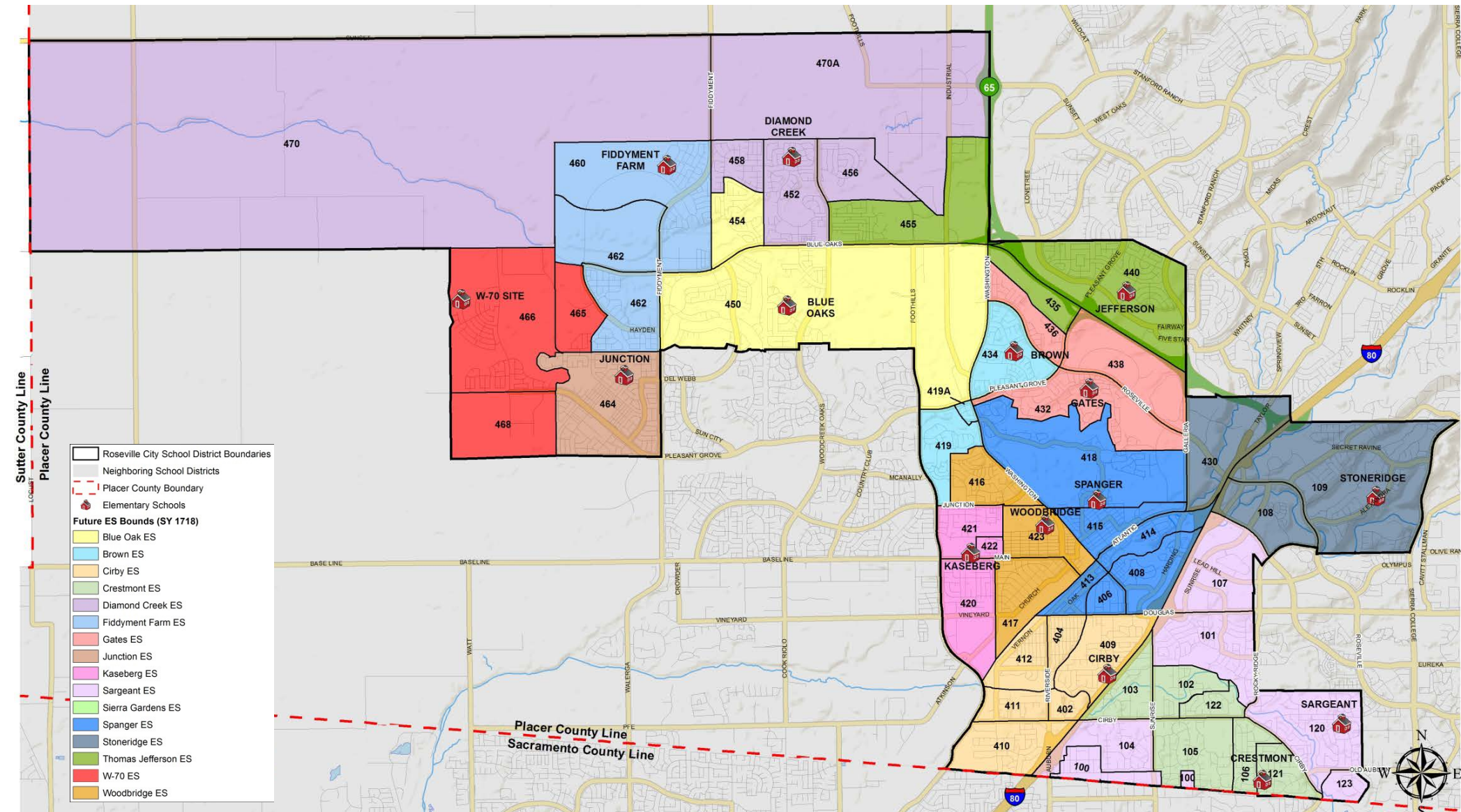



# Approved Attendance Boundaries Opening of F-71 School (2020/2021 est.)

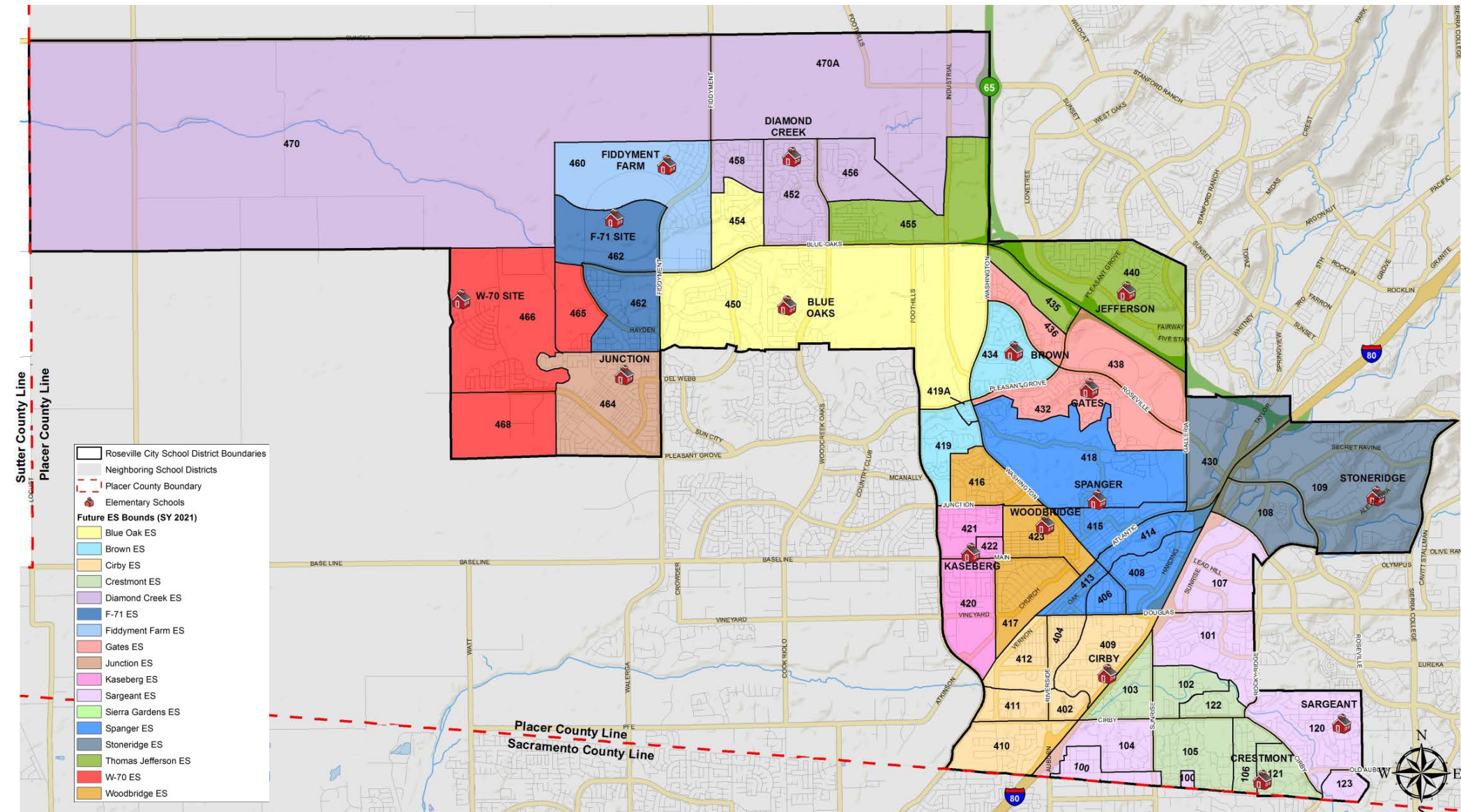



# Approved Attendance Boundaries Opening of WB-80 School (2024/2025 est.)

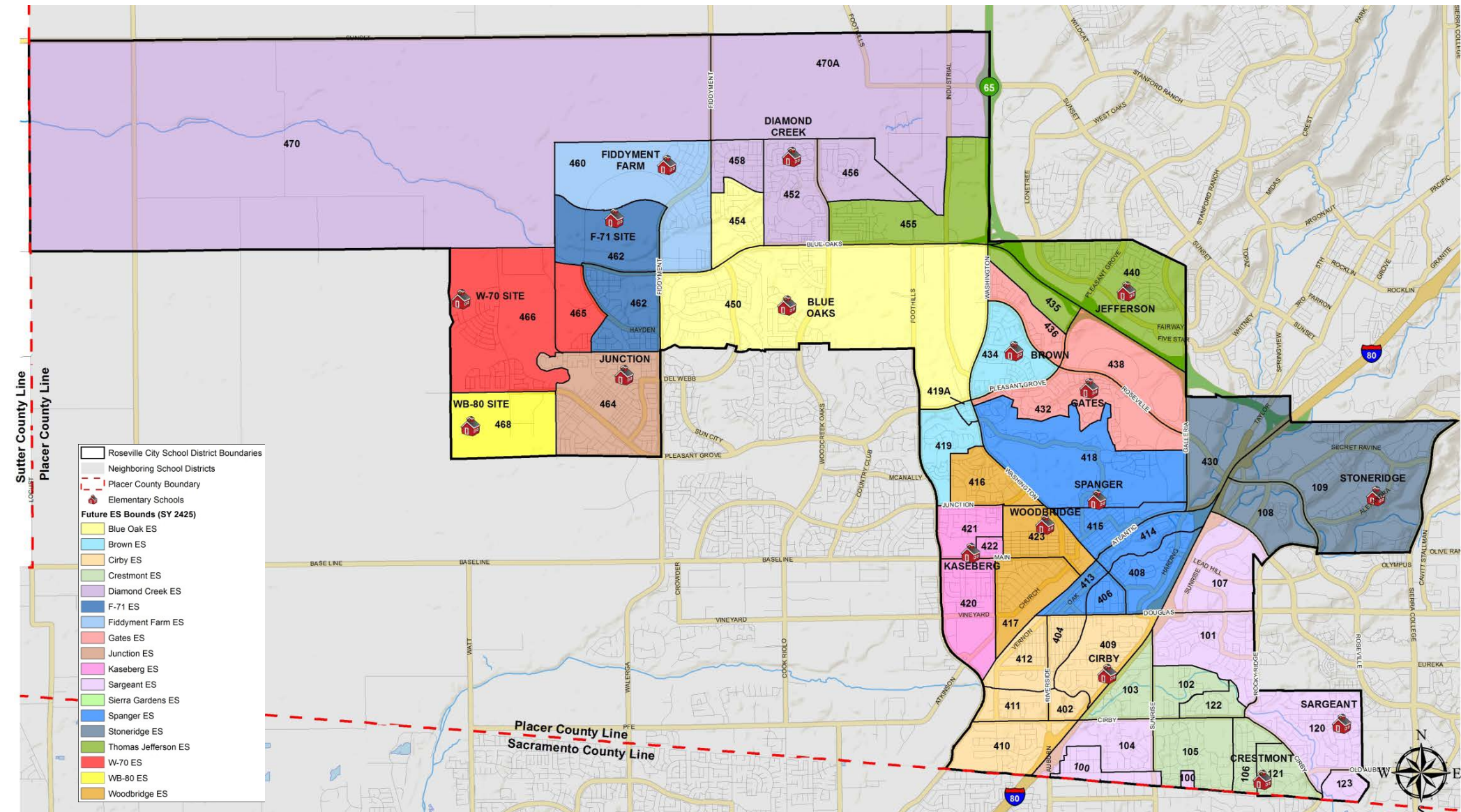



# Approved Attendance Boundaries Opening of C-80 School

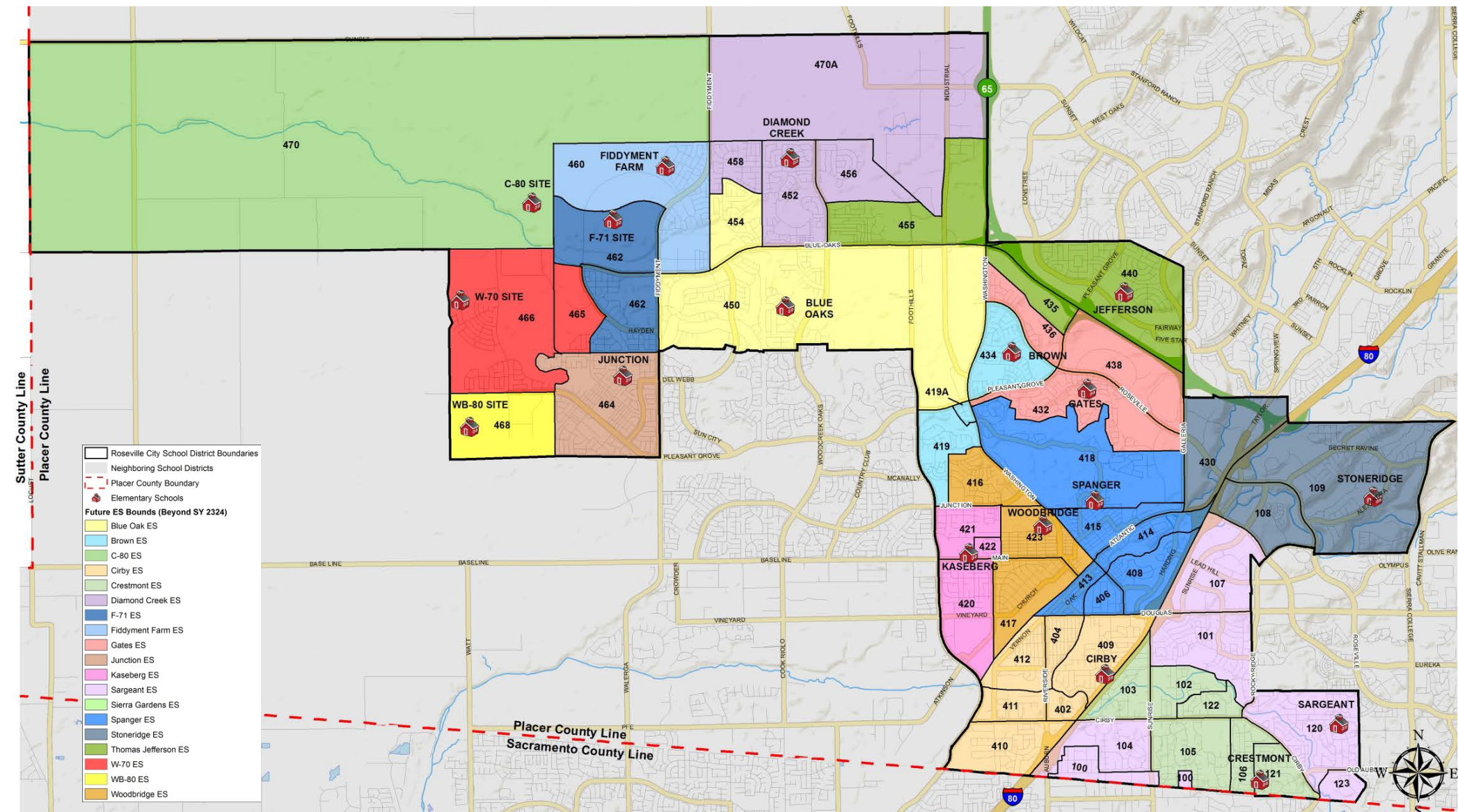



*Site Plan*  
**RCSD W-70 Elementary School**  
 Roseville City School District  
 Roseville, California 95747



03-01-16



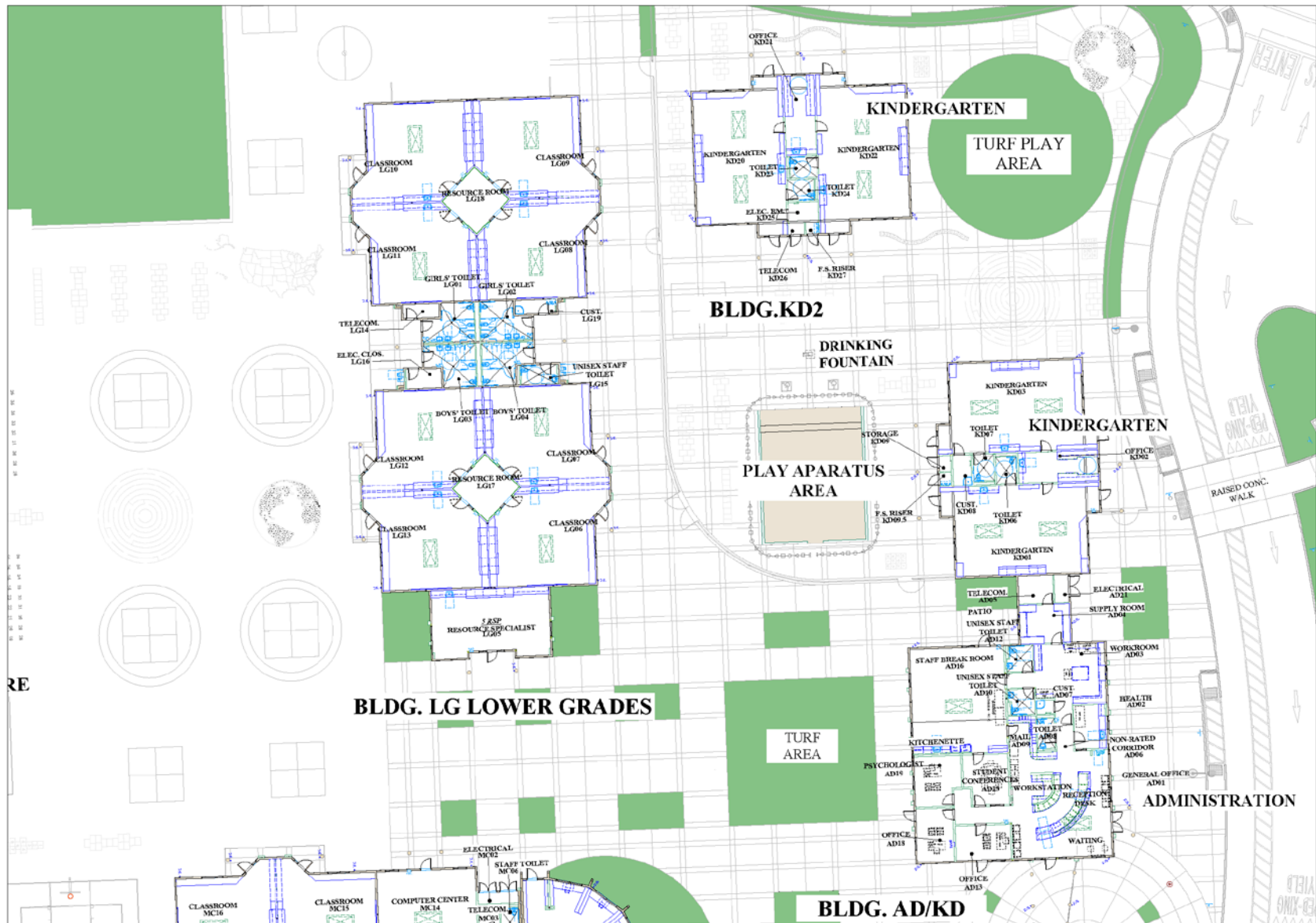

1 FLOOR PLAN  
Scale 3/32" = 1'-0"



*Floor Plan - Bldgs. AD/KD, LG, and KD2*  
*RCSD W-70 Elementary School*

Roseville City School District  
Roseville, California 95747

**DLM**  
ARCHITECTURE

05-01-16



**AERIAL VIEW LOOKING NORTHWEST**

**RCSD W-70 Elementary School**





AERIAL VIEW LOOKING NORTHWEST

RCSD W-70 Elementary School



EYE LEVEL VIEW OF MULTI-USE BLDG.  
AND COVERED WALK TO  
ADMINISTRATION BUILDING

RCSD W-70 Elementary School



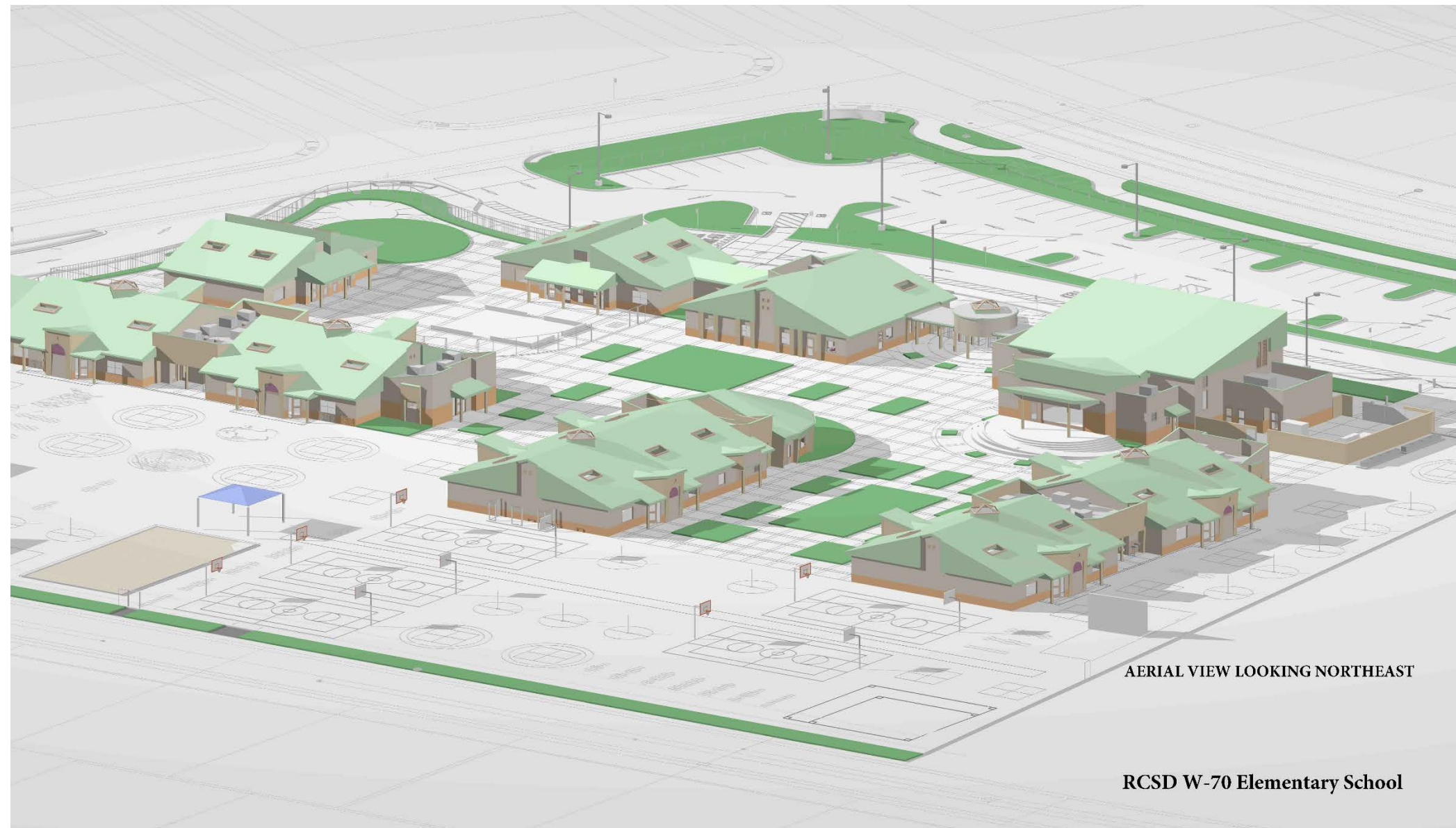

**AERIAL VIEW LOOKING NORTHEAST**

**RCSD W-70 Elementary School**

An aerial architectural rendering of the RCSD W-70 Elementary School. The school is a large, multi-winged building with a prominent central section featuring a green roof and a circular courtyard. Several smaller, single-story buildings with green roofs are arranged around the central area. The campus is surrounded by a large parking lot with numerous spaces, some of which are marked with green landscaping. To the right of the main building, there are two outdoor sports courts, one of which is a basketball court with a blue canopy. The entire scene is set against a light gray background, suggesting a clear sky. The text "AERIAL VIEW LOOKING SOUTHEAST" is visible in the lower right corner of the rendering.

AERIAL VIEW LOOKING SOUTHEAST

RCSD W-70 Elementary School